

USER MANUAL

# SHAKESPEARE'S CHURCH ORGAN

SPITFIRE AUDIO

# CONTENTS

INTRODUCTION	3
WELCOME	4
DOWNLOADING & INSTALLING	5
THE SPITFIRE APP PREFERENCES	6
THE DEDICATED PLUGIN	7
SHAKESPEARE'S CHURCH ORGAN INTERFACE	8
MAIN CONTROLS	11
MIXER/MICS	12
TOP MENU	13
WHAT'S INCLUDED, PRESETS & MIC MIXES	14
APPENDIX A - FAQs AND TROUBLESHOOTING	17
APPENDIX B - DEFAULT CC MAPPINGS	21

# INTRODUCTION

## A voice forged through centuries

The Holy Trinity Church organ, with its origins traced back before the Reformation, stands as a testament to enduring craftsmanship. Developed and lovingly restored over centuries, it comprises an Upper Organ (housing the powerful Great and expressive Swell divisions, along with the foundational Pedal stops) and a Lower Organ (featuring the versatile Choir and a second expressive Swell division, also with its own Pedal stops). The profound sound of the organ has resonated within this listed building's walls for centuries – a witness to history, a voice of devotion. Now, its vast dynamic range, from the most intimate whispers to the commanding pronouncements of its full ensemble, is yours to explore, adding depth, historical weight, and undeniable emotion to any production.

## QUICK SPECS

### MAC SYSTEM REQUIREMENTS

Mac OS X 11 to OS 15

Minimum: 2.8GHz i5 minimum (quad-core), 8GB RAM.

Recommended: 2.8GHz i7 (six-core), 16GB RAM.

Apple Silicon computers are supported and 64 bit DAW required.

(32 bit DAWs not supported)

### PC SYSTEM REQUIREMENTS

Windows 10 and Windows 11. (latest Service Pack, 64-bit)

Minimum: Intel Core 2.8GHz i5 (quad-core) or AMD Ryzen 5, 8GB RAM

Recommended: Intel 2.8GHz i7 (six-core) or AMD R7 2700, 16GB RAM

(32 bit DAWs not supported)

- Download Size ~2.07GB
- Dedicated plugin (AU, VST3, AAX - **VST2 not supported**)

# WELCOME

## **Shakespeare's Church Organ and the RSC**

Recorded for the RSC, the sound of this inspiring church organ was brought to the stage at the Royal Shakespeare Theatre for the 2024 production of Twelfth Night. Played by actor Thom Petty in the role of Curio, the organ masterfully underscored the story's light and dark moments, weaving everything from solemn funeral marches to American baseball tunes Ragtime into the fabric of the play. From the organ's 54 ranks, arranged into five divisions, we created the most characterful and commonly used registrations, providing composers and producers with a comprehensive range of authentic and inspirational organ sounds that sound equally at home in the theatre and in larger arrangements. The unique acoustics of the Holy Trinity Church were captured with three microphone positions, resulting in clarity through close mics, as well as a rich, distinctive sound imbued with both grandeur and an ethereal atmosphere that carries centuries of history within its resonance.

## **About the Holy Trinity Church pipe organ**

In the heart of Stratford-upon-Avon, England, lies the Church of the Holy Trinity – a Grade I listed building with an incredible story. This spectacular historical site is where William Shakespeare, the most celebrated playwright in the English language, was baptised, worshipped and is buried. In a unique collaboration with the Royal Shakespeare Company (RSC), the magnificent and reverent sound of the pipe organ was captured, recording many tonal combinations in the glorious acoustics of the Holy Trinity Church, and bringing it to life on stage for their production of Twelfth Night. A deeply moving instrument heard in church services over centuries, now the timeless and transformative voice of this historic organ can be used to evoke the poetic spirit of the Bard, William Shakespeare, into your own scores.

# DOWNLOADING & INSTALLING

Thank you for buying Shakespeare's Church Organ. If you are new to Spitfire Audio you can get up to speed here: <https://www.spitfireaudio.com/about/>

First though, grab the 'Spitfire Audio App' from this link, this app will enable you to download the library: <http://www.spitfireaudio.com/info/library-manager/>

## THE SPITFIRE AUDIO APP

When you launch the app you will be prompted to login using the same details you use at our site. Then you'll see the page pictured below:

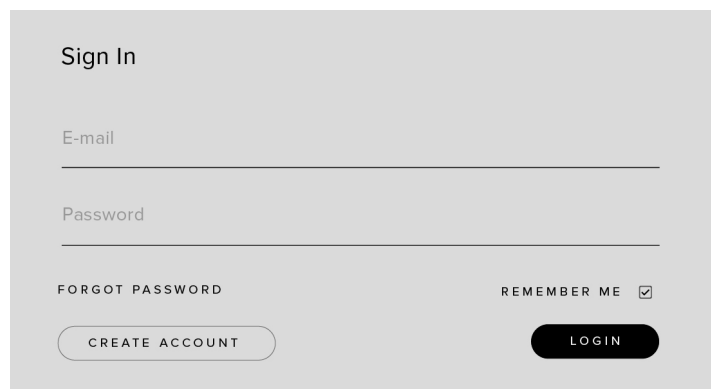

**1. TABS** the default tab is My Products, which shows all of the libraries on your Spitfire Account. Downloads will show currently downloading products.

**2. FILTERS** Clicking these filters will quickly display products you've yet to install, those already installed, and any available updates. Clicking again will remove the filter.

**3. LIBRARY** All libraries and plugins in your collection will appear with their artwork on the My Products tab. Clicking this artwork will open the product page. This is a great place to find information such as system requirements and instructions as well as Reset and Repair options.

**4. INSTALL/UPDATE** buttons allow you to quickly start a download directly from the My Products tab, instead of clicking through to the Library. Next to the button the size of the download is shown.

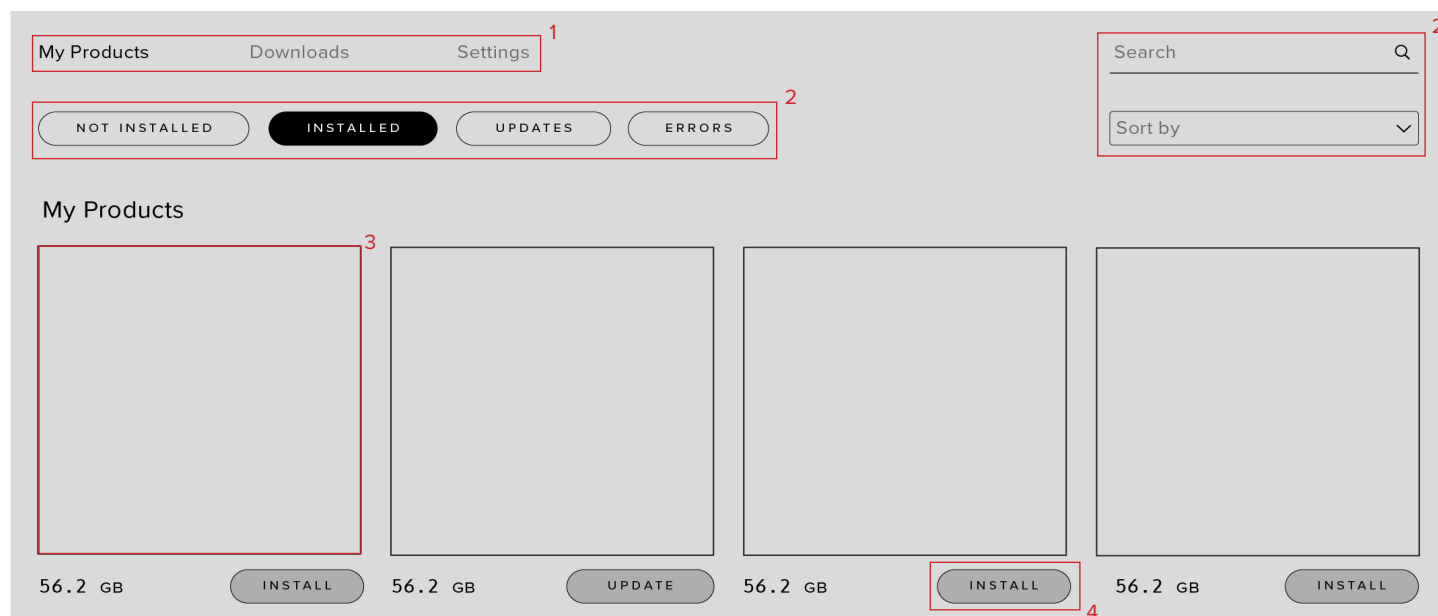

# THE SPITFIRE APP PREFERENCES

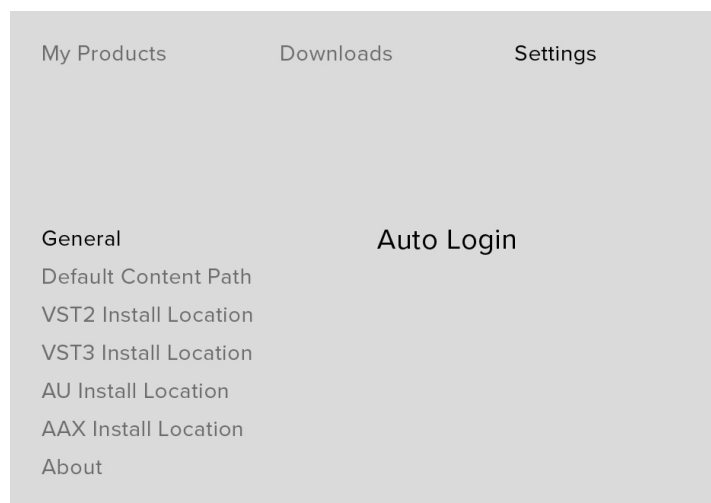

If this is your first time using the Spitfire Audio App for a download you may wish to first navigate to the Settings tab. Here you can set the Default Content location for where you wish to download your libraries. You can also you can set the default VST2 install location to the folder where your DAW expects to find VST files.

Here you can also enable Auto Login to save time in future.

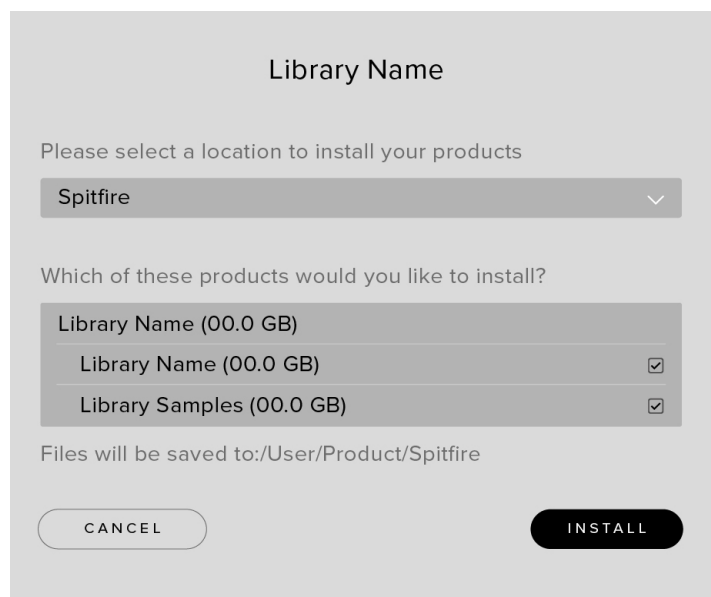

Once you are happy with your preferences, click the Install button for the library. This is either directly on My Products tab under the library artwork, or it can be found by clicking on the library image and clicking the install button on the page that appears.

Clicking either of these will prompt you for a location, the default content location in your preferences will be suggested but you can select any suitable location. If installing from a hard drive, ensure that you choose the drive as the location.

Once you are happy with the location click Download.

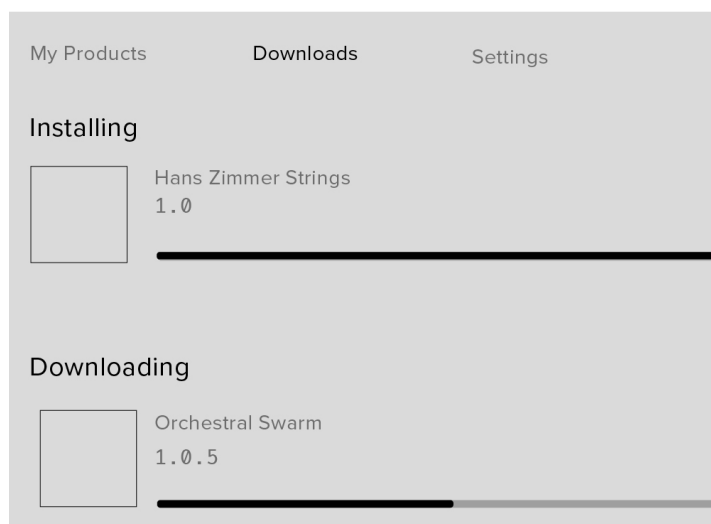

After clicking install you will be directed to the Downloads tab where you can watch the progress if you like. You can of course leave the Downloads tab and start other downloads but at this point you should leave the Spitfire App open until the download completes.

# THE DEDICATED PLUGIN

Spitfire Ensemble is its own, self contained plugin built for VST3, AU and AAX, so once you've downloaded and installed you're ready to go.

## LOGIC PRO X

- On a fresh project, a track dialogue box will automatically pop up.
- Choose 'Software Instrument', and then look beneath the 'Instrument' dropdown.
- Select AU Instruments > Spitfire Audio > Spitfire Ensemble.

## CUBASE

- Right-click the track window and choose 'Add Instrument Track'.
- Underneath the 'Instrument' dropdown, choose Spitfire Ensemble.
- Select 'Add Track'.

## PRO TOOLS

- Go to the 'Track' menu at the top of the screen, and select 'New'.
- In the pop-up, select Stereo and Instrument Track, and press 'Create'.
- In the first Insert slot, select multichannel plug-in and 'Instrument'.
- You should see Spitfire Ensemble available as an option.

# SHAKESPEARE'S CHURCH ORGAN INTERFACE



## MAIN CONTROLS

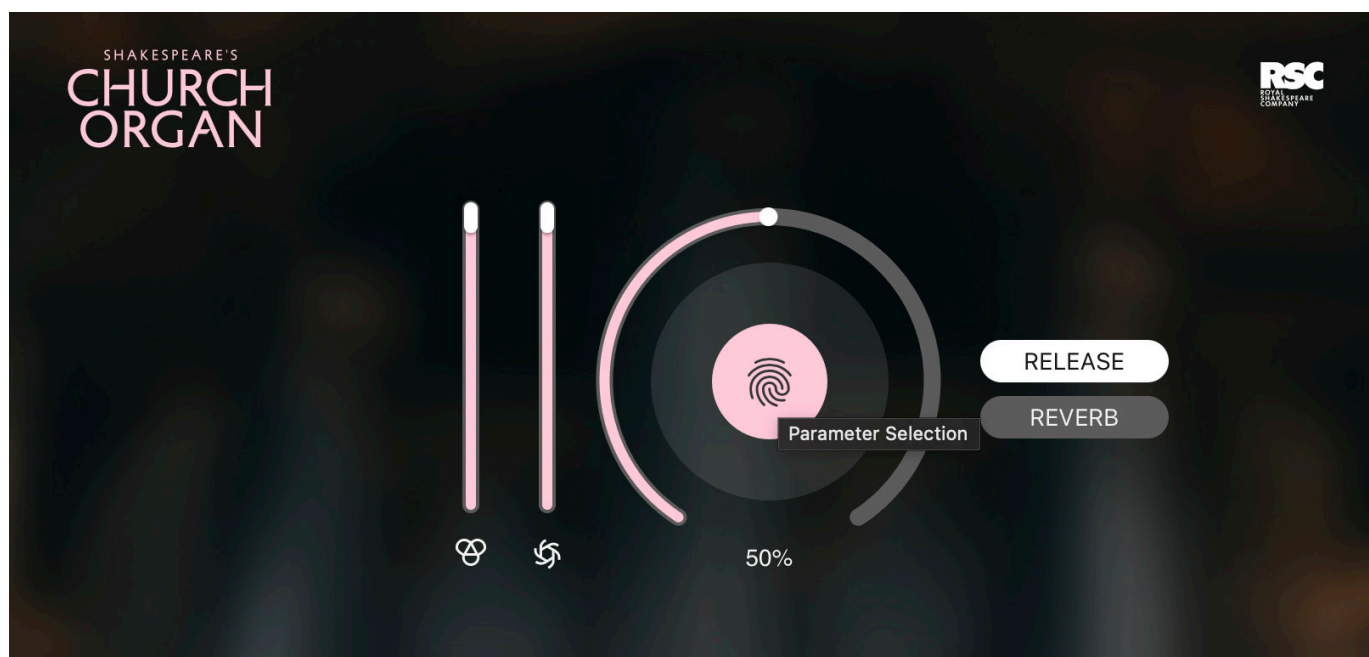



## MIXER/MICS

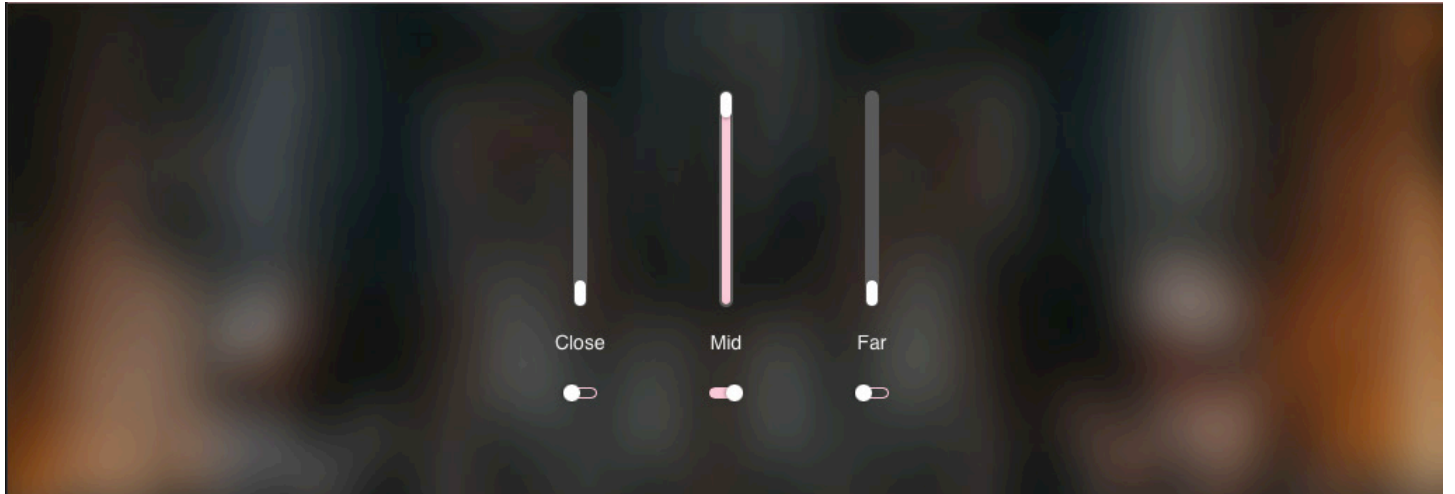

## KEYBOARD



# PRESET SELECTOR



## 1. PRESET NAME

Here you can see the currently selected preset.

## 2. PRESET LIST

Scroll through the list of presets here. Then simply click on a preset to load.

# SHAKESPEARE'S CHURCH ORGAN MAIN CONTROLS

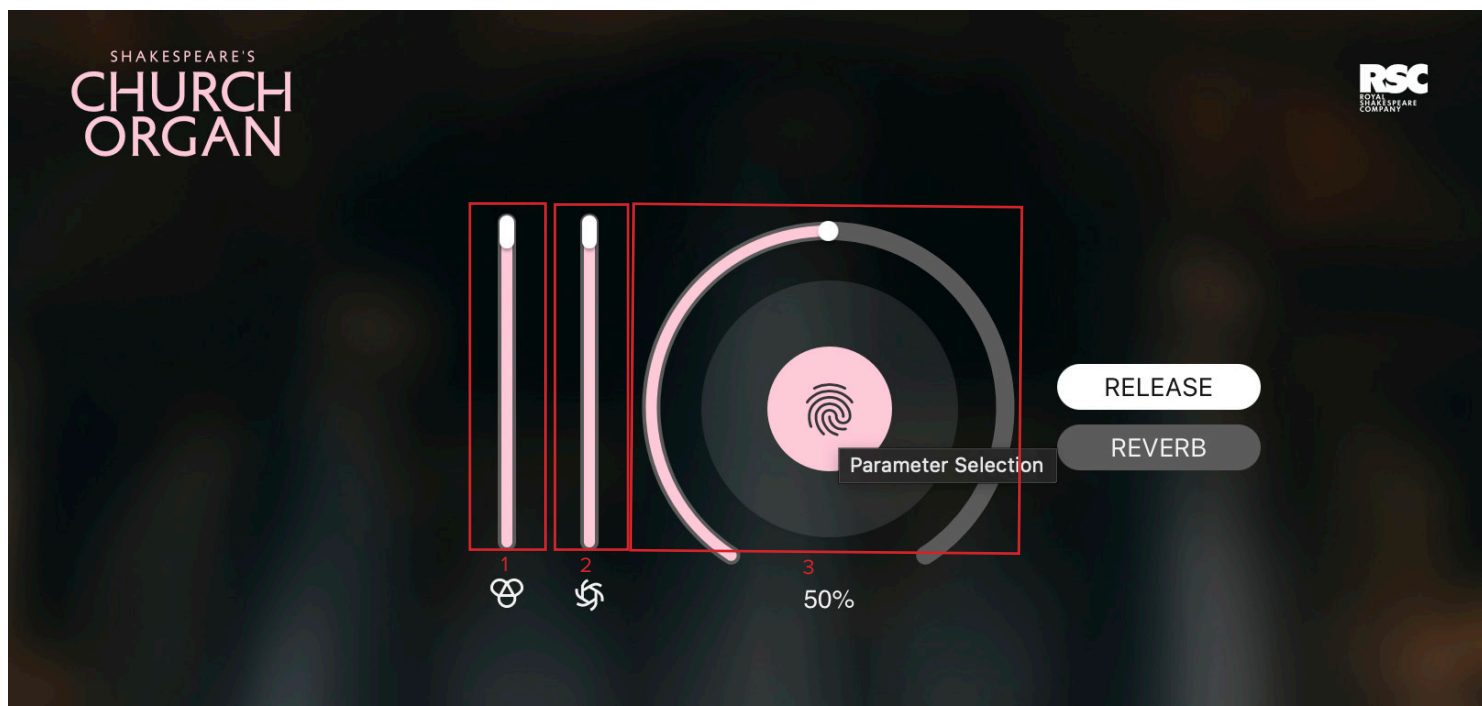

## 1. EXPRESSION

Adjusts the level of the technique

## 2. DYNAMICS

This will increase or decrease the dynamic being played.

## 3. KNOB

The configurable knob allows you to control any of the other available parameters for the particular technique.

Hover over the knob and it will turn black.

**3.1 CLICK:** Click and you will be able to assign any of the remaining available controls to the knob.

Right click on any of these controls to assign them to a MIDI controller. Remember that if you assign a MIDI controller to a parameter via the knob, the MIDI controller will follow the parameter rather than being permanently assigned to the knob.

**RELEASE:** Allows you to change the amount of release trigger you hear.

**REVERB:** Controls the amount of reverb being added.

# MIXER/MICS

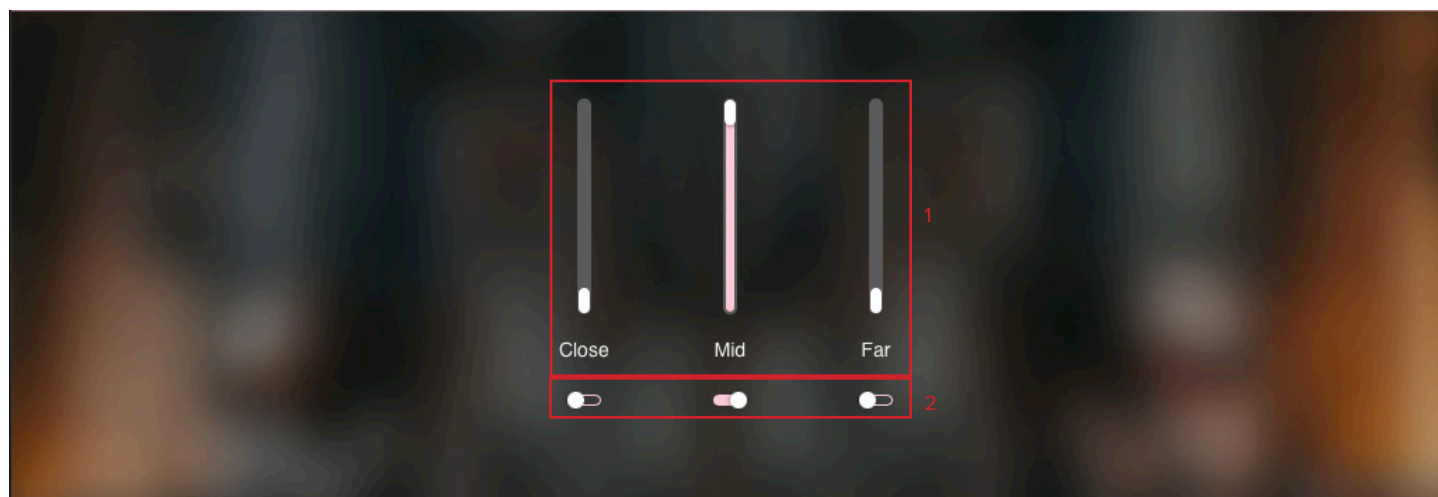

## 1. SIGNAL FADER

Adjust the level of each signal here, right-click to learn MIDI cc# automation.

## 2. SIGNAL ON/OFF

Here you can turn signals on or off (you can also turn them on by fading them up). If you turn a signal on, pay attention to the LED in the top left of Impressionism, if it is flashing red, it means that the samples are still loading into RAM and you should wait before playing again to avoid glitches.

# TOP MENU



## 1. TUNE

Move this knob to tune in increments of 0.01 of a semitone. CMD/CTRL-click to reset to default.

## 2. PAN

Pan the signal left / right. CMD/CTRL-click to reset.

## 3. VOLUME

Control the overall volume of the instrument.

## 4. PLUGIN VOLUME METER

Visual representation of the overall output volume of the instrument.

# WHAT'S INCLUDED, PRESETS AND MIC MIXES

At the heart of this library are 54 individual ranks, which in combination result in a wide range of timbral possibilities. To unlock the expressive potential of the organ, we've created 33 presets, each representing a carefully chosen registration (a specific combination of stops).

These presets are presented based on their primary pitch range: 11 Manual Registrations, designed for sounds primarily played on the organ's keyboards, and 4 Pedal Registrations, featuring sounds focused on the lower pitches controlled by the pedal keyboard.

We've explored even richer sonic textures in an additional 18 Combination Presets, which layer and blend sounds from both the manuals and the pedals, offering complex and evocative tonal landscapes.

## **ORGAN MANUAL PRESETS:**

**Full Organ** - the organ at its most powerful, utilising a wide range of stops for a grand and majestic sound, ideal for dramatic chords and soaring melodies.

**Less Full Organ** - A slightly more restrained version of the "Full Organ", offering a balanced and versatile sound suitable for a variety of musical contexts.

**Soft Flutes** - Emphasises the delicate and gentle tones of the flute stops, creating a light and airy sound perfect for intimate passages and ethereal textures.

**Soft Strings** - Evokes the warm and mellow sound of string stops, providing a smooth and expressive tone for lyrical melodies and gentle harmonies.

**Bright** - An emulation of an iconic organ sound with distinctive vibrato and bright character.

**Reeds** - Showcases the bold and vibrant sound of the reed stops, offering a powerful and assertive tone for fanfares and dramatic

statements.

**Brass** - Focusses on the bright and resonant sound of the brass stops, ideal for adding brilliance and power to your compositions.

**Soft Bach** - Designed for Baroque music, this preset provides a clear and articulate sound well-suited for counterpoint and intricate passages.

**Diapason** - The fundamental and foundational sound of the diapason stops, offering a rich and warm tone that forms the core of the organ's sound.

**Cornet** - The bright and piercing sound of the cornet stops, adding a distinctive and soloistic quality.

**Solo Trumpet** - The clear and brilliant sound of the trumpet stop, perfect for soloistic melodies and fanfare.

## **ORGAN PEDAL PRESETS:**

This section focusses on the sounds of the organ's pedal board, providing 4 presets:

**Smallest** - This preset uses the quietest pedal stops for a subtle and delicate bass foundation.

**Small** - Offers a slightly fuller sound than "Smallest", providing a clear and defined bass line.

**All (No Reeds)** - Utilises all the pedal stops except for the reed, creating a powerful but smooth bass sound.

**All** - This preset uses all available pedal stops for the fullest and most powerful bass sound, providing a deep and resonant foundation.

# WHAT'S INCLUDED, PRESETS AND MIC MIXES

## **COMBINATION PRESETS:**

18 presets that combine sounds from both the manual and the pedals, providing a wide range of pre-blended fixtures:

**Full Organ Pedal Reeds** - Combines the Full Organ manual preset with reed stops from the pedal, creating a massive and powerful sound.

**Full Organ** - Combines Full Organ with all non-reed pedal stops for a full sound with a smoother bass.

**Full Congregation** - Designed to evoke the sound of a church service, combining Less Full Organ and Pedal All (No Reeds) presets.

**Lighter Congregation** - Combines Less Full Organ with Pedal Small presets, creating a gentle and intimate texture. A lighter and more delicate version, ideal for quieter moments.

**Soft Flutes** - Layers the Soft Flutes manual preset with the quietest pedal stops for a delicate and ethereal sound.

**Strings Chorale** - Combines Soft Flutes and Soft Strings with the Smallest pedal preset, creating a beautiful and harmonically rich texture.

**Strings Ethereal** - Layers Soft Strings with the "Small" pedal preset, for a smooth, atmospheric sound.

**Fanfare** - Combines the Reeds and Brass manual presets with all pedal stops for a triumphant and celebratory sound.

**Simple Bach** - Designed for playing Bach's music, combining the Diapason manual preset with the Small pedal preset, offering a clear and articulate sound.

**Fanfare and Solos** - Layers the Cornet, Solo Trumpet and Brass manual presets with all pedal stops for a bright and virtuosic sound.

**Final Verse** - Combines Diapason & Solo Trumpet & Pedal all no reeds.

**Full Fanfare** - Combines the bright and powerful sounds of the Reeds, Brass and Solo Trumpet with the full and resonant sound of Pedal All No Reeds. Designed for creating triumphant and celebratory fanfares, adding grandeur and excitement.

**Classical Flutes** - Layers the clear and articulate sound of Soft Bach with the delicate bass foundation of the Smallest pedal preset. Ideal for evoking the sound of Baroque music and creating elegant, refined textures.

**Festive Full Organ** - Combines the foundational Diapason and vibrant Reeds manual presets with the powerful sound of the Pedal no Reeds to create a rich and celebratory sound.

**Restrained Organ** - A more subtle and nuanced sound, combining the balanced Less Full and soloistic Solo Trumpet manual presets with the full sound of the Pedal All No Reeds. Perfect for adding depth and texture without overpowering the other elements in your mix.

**British Bach** - This preset evokes the sound of English Baroque music, layering the clear and articulate "Soft Bach" and smooth "Soft Strings" manual presets with the delicate bass of the "Pedal Smallest" preset.

**Full French** - This preset is designed for creating a grand and dramatic French Romantic organ sound. It combines the powerful "Long Full" and "Long Brass" manual presets with the full sound of the "Pedal all no reed" preset.

**Glory Days** - Creates a rich and majestic sound by combining the foundational "Long diapason" and vibrant "Long reeds" manual presets with the defined bass of the "Pedal small" preset.

# WHAT'S INCLUDED, PRESETS AND MIC MIXES

## MIC MIXES

Control the spatial character of the organ with three microphone positions:

Close  
Mid  
Far

Allowing you to shape the sound from intimate to expansive.



# APPENDIX A — FAQS AND TROUBLESHOOTING

## Q: WHAT ARE THE SYSTEM REQUIREMENTS?

### MAC SYSTEM REQUIREMENTS

Mac OS 11 - OS 15  
Minimum: 2.8GHz i5 (quad-core), 8GB RAM

Recommended: 2.8GHz i7 (six-core), 16GB RAM

32 bit is no longer supported. Apple Silicon / ARM is supported.

### PC SYSTEM REQUIREMENTS

Windows 10 and Windows 11. (latest Service Pack, 64-bit)

Minimum: Intel Core 2.8GHz i5 (quad-core) or AMD Ryzen 5, 8GB RAM

Recommended: Intel 2.8GHz i7 (six-core) or AMD R7 2700, 16GB RAM

## Q: I WANT TO RESET THE PLUGIN SETTINGS TO THE DEFAULT

You can delete the .settings file to reset the settings to default. This is located at:

Users/username/Music/Spitfire Audio - on a Mac

C:\Users\username\AppData\Roaming\Spitfire Audio - on a PC.

## Q: MY LIST OF PRESETS IS EMPTY, HOW DO I SOLVE THIS?

If you have moved your Ensemble Library folder, you can solve this problem by using the “Locate Library” feature in the Spitfire Audio App.

If this does not solve the problem, the library likely needs reauthorising, to do this, use the “repair” feature in the Spitfire Audio App.

## Q: I SEE A RED EXCLAMATION MARK IN THE TOP LEFT OF SHAKESPEARE’S CHURCH ORGAN, WHAT DOES THIS MEAN?

This means that there is an error, you can click the exclamation mark to open a log with further details. It is likely that using the “Repair” and “Locate Library” features in the Spitfire Audio App will solve the problem but if not, contact our support team at [spitfireaudio.com/support](https://spitfireaudio.com/support) and attach the log.

## Q: CAN I INSTALL ON MORE THAN ONE COMPUTER?

With our products you have two licenses. This means that you are allowed to download and install on two computers you own, say your main rig and your mobile rig. If you have purchased the library on a hard drive, you should copy the contents of the drive on to the destination machine before completing the download with the Spitfire App. If you downloaded Shakespeare’s Church Organ, you can copy the library folder over to the second machine and then use the “Repair” and “Locate Library” features in the Spitfire Audio App.

## Q: I CAN’T SEE THIS IN THE KONTAKT LIBRARIES PANE AND WHEN I TRY AND LOAD IT INTO KONTAKT IT SAYS NO LIBRARY FOUND

This library does not run in Kontakt, it is a standalone plug-in that you can run in your chosen DAW.

## Q: HOW DO I AUTHORIZE SHAKESPEARE’S CHURCH ORGAN ON A MACHINE NOT CONNECTED TO THE INTERNET?

It not possible to authorise Shakespeare’s Church Organ on a machine not connected

to the internet. Authorisation is done with the Spitfire Audio App and an internet connection is required.

## **Q: HOW CAN I REDOWNLOAD A PRODUCT?**

This can easily be done via your Spitfire Audio App. To reset both your entire library download or the latest update;

- Open up the Spitfire Audio App and log in with your account email and password.
- Select the product artwork you wish to re-download
- On this page is a “cog wheel”. Select this, choose “reset” from the menu. Then “Reset Entire Download” (for a full download) or (Latest Update) for the latest update.

This will reset your latest update ready for install again. You can repeat this process for any of the libraries you own.

Note that there is a limit to how many times you can reset your downloads in a certain time frame. If you do exceed your reset limit please get in touch.

## **Q: DIFFICULTIES IN DOWNLOADING / INSTALLING**

Customers may find that they have some difficulties in the downloading process. If you find that you are having some trouble, please check the list below for possible causes:

- The formatting of your drive, if it is FAT32 this will cause errors, because there is a maximum file size with this format of 4GB and our download files will exceed this limit. ExFat format is also not recommended due to possible permissions/decryption issues. To solve this problem, reformat your drive or use a different drive. We recommend NTFS on PC and Mac OS Extended on Mac. Other possible issues:
- Spitfire App freezes in the “Extracting” stage for hours. This may be because our libraries are often very large files, and this

is the stage where the compressed files are extracted and placed in their final locations on the hard drive. There could be hundreds of GB of content to unpack, so it really can take hours. If you’re unsure whether it has crashed or is extracting files, visit the installation folder you chose when you started the install. If everything is working normally you’ll see various files appearing in the folder (or one of its sub-folders).

- If your download gets stuck and is continually cycling and not resuming, please get in touch with us, giving us as much detail as possible about your set up. It would be helpful if you can tell us your operating system, where you are downloading from (your country, and also whether you’re at home or work), your ISP, and whether there are any proxy servers or firewalls between your computer and the internet.

## **Q: I HAVE FAST INTERNET, WHY IS MY DOWNLOAD SLOW?**

We have no direct influence on your actual download speeds, our libraries are hosted on S3 servers which are normally very quick but it may well be that at certain times of the day when traffic is particularly busy, your ISP may throttle your connection speeds.

We would advise you to leave your download running overnight as speeds should ramp up at less busy times. Our Spitfire App downloader aims to use as much of the available bandwidth as possible to give you the quickest possible speeds, and may take several minutes to reach its peak.

## **Q: CAN I TRY BEFORE I BUY?**

No - it is not currently possible to demo our products.

If you go to our Youtube channel you’ll see many walkthroughs containing detailed info about all our products -- you can hear them being played in real time with no smoke and mirrors!

## Q: MY LIBRARIES ARE NOT SHOWING UP IN MY SPITFIRE APP

A handful of customers may find that when they log into their Spitfire App, some of their previously purchased products do not show up in the 'Installed' section or in the 'Download Ready' section either. It may be that you have purchased these under another email address. Checking other possible email addresses for your previous purchases may help to find these missing products. If this is not the case, and these missing products were purchased a few years ago, please create a support ticket telling us your account email address, and any serial numbers you may have to go with these missing products. Our support team can also merge one or more accounts together if you'd like to consolidate all your purchases in one place.

The more information we have, the quicker we can get you back up and running!

## Q: HOW DO I UPDATE MY PRODUCTS?

The main premise of downloading our products is that our Spitfire App downloads into the folder you choose, so it is important to choose the folder above where you want the download to go. The best file path for our products is something very simple, a long file path will cause errors as there is a character limit on how far the Spitfire App can read. We advise a file path of something along the lines of: Samples Drive > Spitfire Audio

When it comes to downloading / updating - if you have a folder called 'Spitfire Audio' always point the Spitfire App to the folder Spitfire Audio - never go into this folder and choose the actual library in question.

## Q: HOW DO I REDOWNLOAD THE LATEST UPDATE?

With the continuous improvements to our Spitfire Audio App, we have incorporated the ability to reset your own downloads.

This can easily be done via your Spitfire Audio App.

Open up the Spitfire Audio App and log in with your account email and password.

- Select the product artwork you wish to re-download
- On this page is a "cog wheel". Select this, choose "reset" from the menu. Then "Reset Entire Download" (for a full download) or (Latest Update) for the latest update.
- This will reset your latest update ready for install again.

You can repeat this process for any other updates you wish.

If you do not see the option to reset your download in your Spitfire Audio App, we would advise to download the latest version of the Spitfire App from [spitfireaudio.com/info/library-manager/](http://spitfireaudio.com/info/library-manager/).

## Q: I'VE BEEN WAITING AGES FOR MY DOWNLOAD LINKS?

We run all our orders through a fraud checking process. The automatic fraud check takes 20 minutes (but can take up to an hour during a very busy period, e.g.. Black Friday) If your order gets caught at this stage, we run a manual order check, and this can delay the processing of your order for up to 24 hours.

You should however receive an order confirmation email IMMEDIATELY upon placing your order. This confirms that your order has successfully been logged in our system and that your payment was successfully taken. Please check your junk folders before contacting our support.

## **Q: CAN I DOWNLOAD ON A PC, THEN TRANSFER TO A MAC OR VICE VERSA?**

Yes, you can copy the library folder and plugin files over to the second machine and then use the “Repair” and “Locate Library” features in the Spitfire Audio App. Please note that although the majority of the download can be done on a separate machine, you will always need an internet connection to finish the authorisation process.

## **Q: HOW DO I DOWNLOAD PRODUCTS ON MAC OSX 10.9?**

The version of the Spitfire App needed to install Shakespeare’s Church Organ only supports Mac OS 11 and upwards.

## **Q: I HAVE FOUND A BUG**

In some cases we can’t squash them all and bugs shamefully make their way through. If you think you have found a bug, please contact us with all the relevant information;

- A description of the bug you have found
- A screencast (video) of the bug happening, or an audio example
- The exact preset name (or presets) in question and also the library giving us as much detail as possible will help us get to the bottom of the issue.

## **Q: WHAT IS YOUR REFUNDS / RETURNS POLICY?**

If you have NOT completed the download / installation process, and bought within 14 days then we CAN refund / return your product, please contact support with your account email address and order number so we can handle this quickly. If you HAVE completed the installation process (even if you’ve not yet registered your serial number), please see our EULA in regards to why we do not accept refunds and returns. We can refund hard drive orders up until the point when the drive is dispatched from our office. This is usually 1-2 days after you order.

## **Q: I’VE FORGOTTEN MY PASSWORD?**

If you have forgotten your password, please see this link [spitfireaudio.com/my-account/login/](https://spitfireaudio.com/my-account/login/), and click ‘Forgotten Password’. If at some point in the past you asked us to merge two or more accounts but have since forgotten, you MAY find that the forgotten password isn’t working for the email address you asked us to merge FROM. In this case, please contact support with your name, and any email addresses you think we might know about, and we’ll work out what has happened.

## APPENDIX B — DEFAULT CC MAPPINGS

Dynamics	1
Expression	11
Reverb	17
Release	19

© SPITFIRE AUDIO HOLDINGS LTD  
MMXXV